

User Manual

Contents

1.	Introduction	9
2.	Device description (Fig. 1 - 3)	10
3.	Scope of delivery	11
4.	Proper use	11
5.	Safety instructions	12
6.	Technical data	13
7.	Unpacking	14
8.	Assembly / Before commissioning	14
9.	Start up	17
10.	Cleaning	19
11.	Storage and transport	19
12.	Maintenance	19
13.	Disposal and recycling	20
14.	Troubleshooting	20

FERREX®

WET AND DRY VACUUM CLEANER

F-WDV30P



Translation of original instruction manual

ALDI GUARANTEES THAT OUR EXCLUSIVE BRAND PRODUCTS ARE DEVELOPED TO OUR STRINGENT QUALITY SPECIFICATIONS. IF YOU ARE NOT ENTIRELY SATISFIED WITH THIS PRODUCT, PLEASE RETURN IT TO THE NEAREST ALDI STORE WITHIN 60 DAYS FROM THE DATE OF PURCHASE, FOR A FULL REFUND OR REPLACEMENT, OR TAKE ADVANTAGE OF OUR AFTER SALES SUPPORT BY CALLING THE SUPPLIER’S CUSTOMER SERVICE HOTLINE.

AU

Made in China
FERREX® is a registered trademark of ALDI Stores
DISTRIBUTED BY:
ALDI STORES
1 SARGENTS ROAD
MINCHINBURY NSW 2770
www.aldi.com.au

AFTER SALES SUPPORT

717894

1300 855 831

support@scheppach.com.au

MODELL:
F-WDV30P

03/2025

5

YEAR

WARRANTY

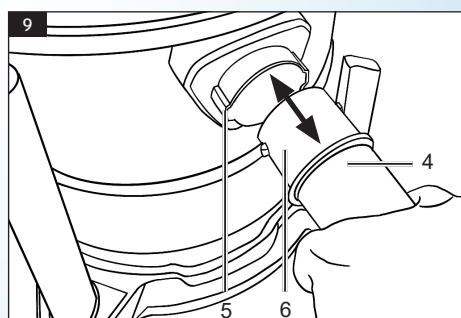
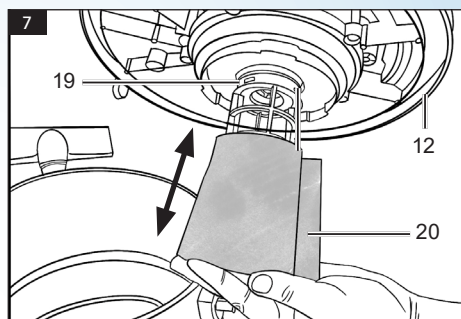
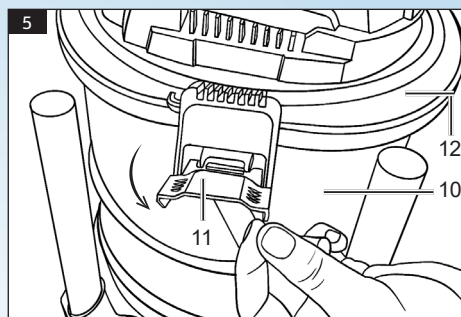
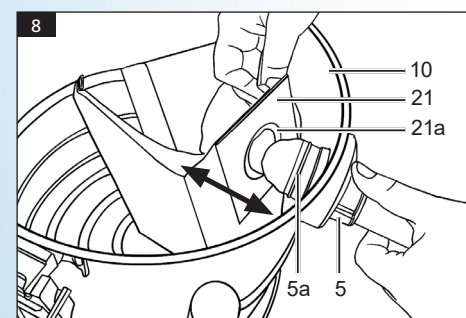
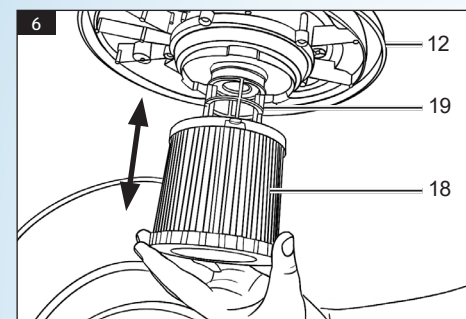
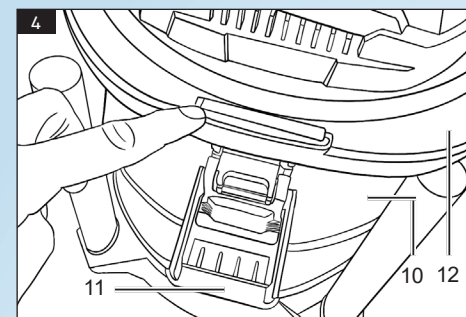
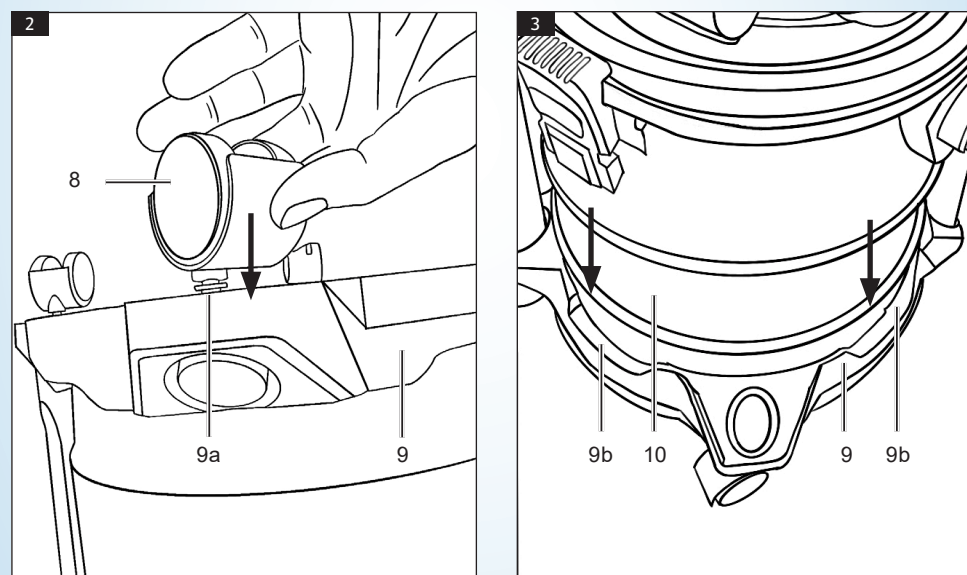
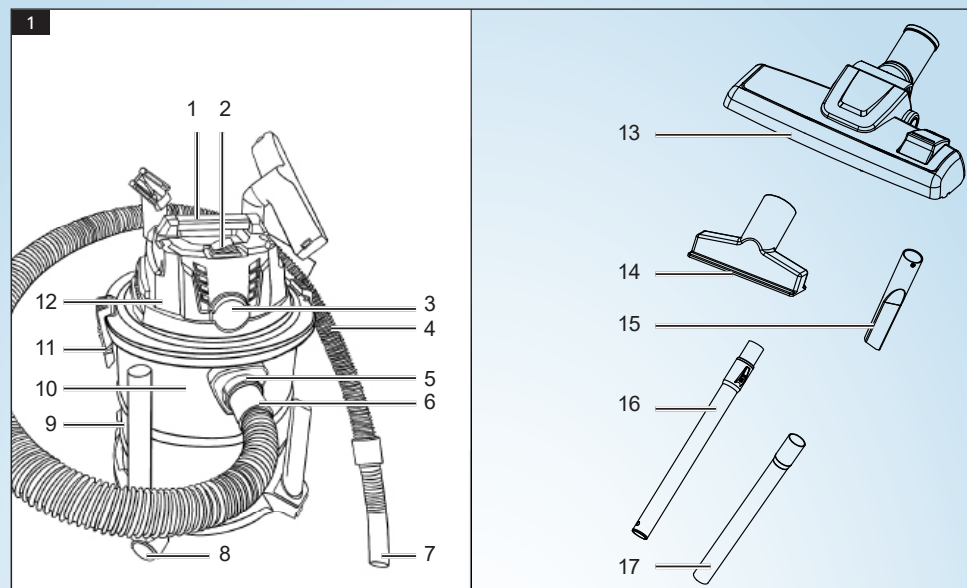

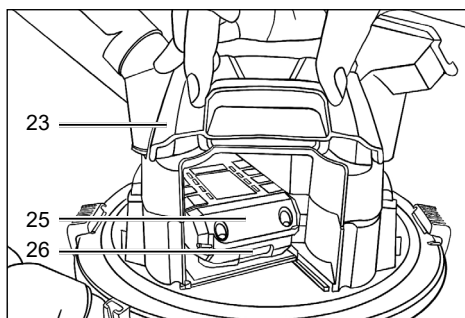
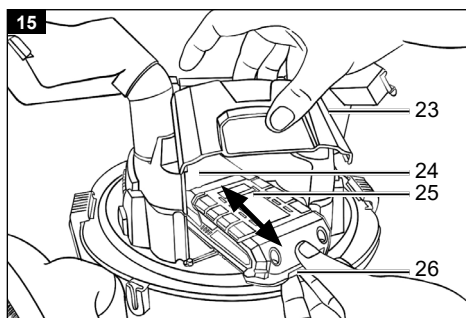
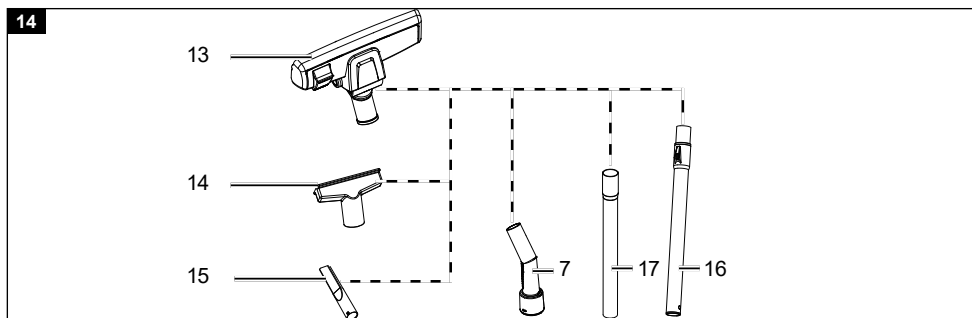
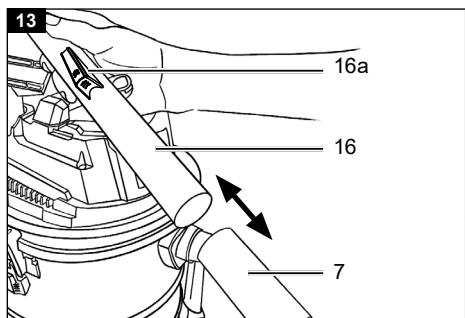
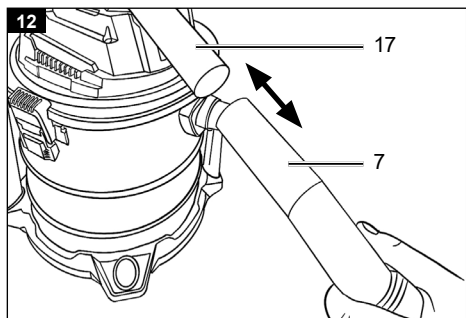
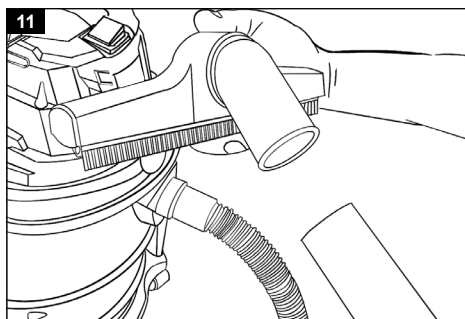
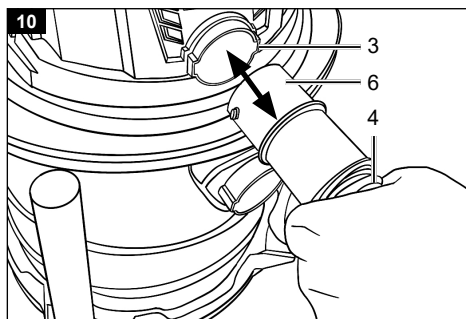

Scope of delivery

- 1 x Wet and dry vacuum cleaner
- 1 x Suction hose
- 1 x Foam filter
- 1 x Paper filter bag
- 1 x Floor nozzle
- 1 x Crevice nozzle
- 1 x Upholstery nozzle
- 1 x Extension tube
- 4x Castors
- 1 x Operating manual
- 1 x Warranty card

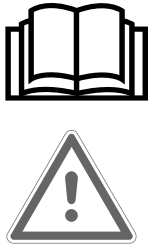

Explanation of the symbols on the device

	Before commissioning, read and observe the operating manual and safety instructions!
	The RCM Mark (Regulatory Compliance Mark) indicates that the product complies with the relevant guidelines of the ACMA as well as corresponding government requirements for the safety of electrical devices.
	5 Year warranty.

1. Introduction

Congratulations on your purchase of this FERREX® product.

All FERREX® products, are manufactured to the highest standards of performance and safety and are secured by our comprehensive 5-year warranty as part of our customer service.

We hope you will enjoy your purchase for many years to come.

Note:

In accordance with the applicable product liability laws, the manufacturer of this device assumes no liability for damage to the device or caused by the device arising from:

- Improper handling
- Failure to comply with the operating instructions,
- Repairs carried out by third parties, unauthorised specialists.
- Installing and replacing non-original spare parts,
- Application other than specified.

Recommendations:

Read through the complete text in the operating manual before installing and commissioning the device.

This operating manual should help you to familiarise yourself with your device and to use it for its intended purpose.

The operating manual includes important instructions for safe, proper and economic operation of the device, for avoiding danger, for minimising repair costs and downtimes, and for increasing the reliability and extending the service life of the device.

In addition to the safety instructions in this operating manual, you must also observe the regulations applicable to the operation of the device in your country.

Keep the operating manual at the device, in a plastic sleeve, protected from dirt and moisture. They must be read and carefully observed by all operating personnel before starting the work. The device may only be used by personnel who have been trained to use it and who have been instructed with respect to the associated hazards. The required minimum age must be observed.

In addition to the safety instructions in this operating manual and the separate regulations of your country, the generally recognised technical rules relating to the operation of such machines must also be observed.

We accept no liability for accidents or damage that occur due to a failure to observe this manual and the safety instructions.

2. Device description (Fig. 1 - 3)

1. Carrying handle
2. On/Off switch
3. Blowing connection
4. Suction hose
5. Suction connection
- 5a. Bar (inside of metal container)
6. Hose coupling
7. Handle
8. Castors
9. Base frame
- 9a. Mounting holes (base frame)
- 9b. Locking mechanism (base frame)
10. Metal container
11. Locking mechanism (metal container)
12. Container lid
13. Floor nozzle
14. Upholstery nozzle
15. Crevice nozzle
16. Extension tube
- 16a. Release button (extension tube)
17. Suction pipe
18. Filter cartridge
19. Filter basket
20. Foam filter
21. Paper filter bag
- 21a. Sealing ring (paper filter bag)
22. Holders (suction pipe/suction hose/nozzles)
23. Cover (battery)
24. Battery holder
25. Battery (not included)
26. Release button (battery)

3. Scope of delivery

- 1 x Wet and dry vacuum cleaner
- 1 x Suction hose
- 1 x Foam filter
- 1 x Paper filter bag
- 1 x Floor nozzle
- 1 x Crevice nozzle
- 1 x Upholstery nozzle
- 1 x Extension tube
- 4 x Castors
- 1 x Operating manual
- 1 x Warranty card

4. Proper use

The wet and dry vacuum cleaner is suitable for wet and dry vacuuming using the appropriate filter. The device is not intended for vacuuming flammable, explosive or harmful substances.

The machine may only be used in the intended manner. Any use beyond this is improper. The user/operator, not the manufacturer, is responsible for damages or injuries of any type resulting from this.

Please note that our equipment was not designed with the intention of use for commercial or industrial purposes. We assume no guarantee if the device is used in commercial or industrial applications, or for equivalent work.

5. Safety instructions

General safety instructions

Attention!

- All repair work, also to any electrical components, must be carried out by an authorised customer service centre.
- This appliance is not intended for use by persons (including children) with reduced physical, sensory or mental capabilities, or lack of experience and knowledge, unless they have been given supervision or instruction concerning use of the appliance by a person responsible for their safety.
- Children may not play with the device.
- Children should be supervised in order to ensure that they do not play with the device.
- Cleaning and user maintenance must not be carried out by children unsupervised.
- Keep packaging material away from children, there is a risk of suffocation!
- The plug must be removed from the socket-outlet before cleaning or maintaining the appliance.
- Risk of fire. Do not vacuum any burning or glowing particles.
- Do not operate the device in explosive environments.
- If foam forms or liquid escapes, switch off the device immediately or pull out the mains plug!
- Do not use abrasive cleaners, glass or all-purpose cleaners! Do not immerse the device in water.

Certain substances can form explosive vapours or mixtures when they are swirled with the suction air! Never vacuum the following substances:

- Explosive or flammable gases, liquids and dusts (reactive dusts)
- Reactive metal dusts (such as aluminum, magnesium, zinc) combined with strongly alkaline and acidic cleaning agents
- Undiluted strong acids and alkalis
- Organic solvents (such as gasoline, paint thinner, acetone, heating oil).

In addition, these substances can corrode the materials used on the device.

⚠ WARNING!

This power tool generates an electromagnetic field during operation. This field can impair active or passive medical implants under certain circumstances. In order to prevent the risk of serious or deadly injuries, we recommend that persons with medical implants consult with their physician and the manufacturer of the medical implant prior to operating the power tool.

6. Technical data

Model:	F-WDV30P
Nominal voltage:	20 V
Suction performance:	10000 Pa
Suction pipe diameter:	32 mm
Tank capacity:	20 L
Protection category:	IPX4
Weight (without battery)	4.1 kg

Battery and charger specifications

Only use the product in conjunction with XFINITY PLUS® rechargeable batteries and chargers in accordance with the following technical specifications.

Suitable for XFINITY PLUS®

Battery Type: PT176213301 / PT176213302 / PT176213303

Charger Type: M8329A / XZ2000-2400KS / XZ2200-2400KSS (Dual Charger)

Please note the technical specifications for the battery and charger.

7. Unpacking

Open the packaging and carefully remove the device.

Remove the packaging material, as well as the packaging and transport safety devices (if present).

Check whether the scope of delivery is complete.

Check the device and accessory parts for transport damage. In the event of complaints the carrier must be informed immediately. Later claims will not be recognised.

If possible, keep the packaging until the expiry of the warranty period.

Familiarise yourself with the device by means of the operating manual before using for the first time.

With accessories as well as wearing parts and replacement parts use only original parts. Spare parts can be obtained from your specialist dealer.

When ordering please provide our article number as well as type and year of manufacture for your equipment.

⚠ ATTENTION!

The device and the packaging material are not children's toys! Do not let children play with plastic bags, films or small parts! There is a danger of choking or suffocating!

8. Assembly / Before commissioning

⚠ ATTENTION!

Prior to use, ensure that the device has been correctly and fully assembled.

Installing the castors (Fig. 2)

1. Place the base frame (9) on a firm surface with the underside upwards on a firm surface.
2. Place the castors (8) in the mounting holes (9a) provided on the base frame (9).
3. Press the castors (8) into the mounting holes (9a) with light pressure.
4. Turn the base frame (9) over and place it on the castors (8).

Installing container (10) on the base frame (9) (Fig. 3)

- 1 Place the metal container (10) on the base frame (9).
- 2 Press the metal container (10) lightly onto the base frame (9).
- 3 Ensure that the locks (9b) of the base frame (9) engage on the metal container (10).

Fasten and remove the container lid (12) (Fig. 4, 5, 11, 14)

Fasten the container lid:

- 1 Place the container lid (12) on the metal container (10).
- 2 Secure the container lid (12) with the locking mechanism (11).

Remove the container lid:

- 1 Before removing the container lid (12), remove all nozzles (13, 14, 15), the suction pipe (17) and the extension tube (16) from the brackets (22) on the container lid (12).
- 2 Release the locking mechanism (11).

- 3 Lift the container lid (12) off the metal container (10).

⚠ ATTENTION!

Never use the device without filter! Always ensure that the filters are correctly fitted.

Filter and filter bag (Fig. 6, 7, 8)

The product is supplied with the following filters and bags:

Filter cartridge (18): Vacuum fine dust

Foam filter (20): Wet suction

Paper filter bag (21): Dry vacuuming

Note:

- 1 To install/remove the filters and filter bags, remove the container lid (12).
- 2 Always place the container lid (12) upside down.
- 3 After you have fitted/dismantled the desired filter or filter bag, replace the container lid (12) on the metal container (10).

Fitting/removing the filter cartridge (18) (Fig. 6)

Remove:

- 1 Turn the filter cartridge (18) anti-clockwise and remove it from the filter basket (19).

Fitting:

- 1 Push the filter cartridge (18) onto the filter basket (19).
- 2 Turn the filter cartridge (18) clockwise until it is fully engaged in the container cover (12).
- 3 Check that the filter cartridge (18) is correctly installed by pulling gently on the filter cartridge (18).

Fitting/removing the foam filter (20) (Fig. 7)

Remove:

- 1 Pull the foam filter (20) from the filter basket (19).

Fitting:

- 1 Pull the foam filter (20) over the filter basket (19).
- 2 Check that the foam filter (20) is correctly installed and completely encloses the filter basket (19).

Fitting/removing the paper filter bag (21) (Fig. 8)

Remove:

- 1 Remove the paper filter bag (21) from the bar (5a) on the suction connection (5).

Fitting:

- 1 Place the paper filter bag (21) inside the metal container (10) on the bar (5a) on the suction connection (5).
- 2 Check that the paper filter bag (21) is correctly installed and that the sealing ring (21a) completely encloses the bar (5a) on the suction connection (5).

Connect the suction hose (4) (Fig. 9, 10)

Suction function

- 1 Push the hose coupling (6) into the suction connection (5).
- 2 Turn the hose coupling (6) clockwise until it is fully engaged.
- 3 Check that the suction hose (4) is correctly installed by pulling lightly on the hose coupling (6).

Blowing function

- 1 Push the hose coupling (6) into the blowing connection (3).
- 2 Turn the hose coupling (6) clockwise until it is fully engaged.
- 3 Check whether the suction hose (4) is correctly installed by pulling lightly on the hose coupling (6).

Uncouple the suction hose (4) from the suction connection (5) or the blow connection (3) (Fig. 9, 10):

- 1 Turn the hose coupling (6) anti-clockwise.
- 2 Pull the hose coupling (6) out of the suction connection (5) or the blow connection (3).

Storing the nozzles (13, 14, 15), suction tube (17) and extension tube (16) (Fig. 11)

You can store the nozzles (13, 14, 15), the suction tube (17) and the extension tube (16) in the holders (22) on the container lid (12) and in the base frame (9).

Attach the suction tube (17) or extension tube (16) (Fig. 12, 13)

You can adjust your individual size on the extension tube.

- 1 Attach the suction tube (17) or extension tube (16) to the handle (7).
- 2 To extend the extension tube (16), push the release button (16a) forwards and hold it in this position.

- 3 Bring the extension tube (16) to the desired length and release the release button (16a) again.

Using the various nozzles (13, 14, 15) (Fig. 1, 14)

Floor nozzle (13):

Vacuuming solids and liquids on medium to large surfaces, carpets or floor mats.

Use the floor nozzle (13) in conjunction with the extension tube (16) or the suction tube (17) - If necessary, it can also be used without the extensions.

Upholstery nozzle (14):

Vacuuming solids and liquids on seating furniture, sofa sets and upholstered surfaces.

Crevice nozzle (15):

Vacuuming solids and liquids in crevices, corners, radiators and hard-to-reach areas

Attaching the nozzle

- 1 Attach the desired nozzle (13, 14, 15) to the handle (7) or the extension tube (16) or suction tube (17).
- 2 Remove the nozzle by pulling it forwards out of the respective connection (7, 16, 17).

9. Start up

⚠ ATTENTION!

Always make sure the device is fully assembled before commissioning!

⚠ WARNING!

Switch the device off if liquid or foam emerges with the exhaust air during wet vacuuming.

Insert/remove the battery (25) in the battery holder (24) (Fig. 15, 16)

Insert the battery

- 1 Open the cover (23).
- 2 Slide the battery (25) into the battery holder (24). The battery (25) audibly clicks into place.
- 3 Close the cover (23).

Remove the battery

- 1 Open the cover (23).
- 2 Press the release button (26) on the battery (25) and pull it out of the battery holder (24).
- 3 Close the cover (23).

Switching on/off (Fig. 1)

- Press the ON/OFF switch (2) to the “I” position to switch on.
- Push the ON/OFF switch (2) into position “0” to switch the device off.

Overload protection

If the motor is overloaded, it switches off automatically. The motor can be switched on again after a cool-down period (time varies).

Wet suction

When the metal container (10) is full, a float located in the filter basket (19) closes the suction opening and the suction process is interrupted.

Switch off the product and empty the metal container (10).

The metal container (10) is not suitable for storing liquids. Empty the metal container (10) after wet vacuuming.

Blowing function

- 1 Attach the hose coupling (6) to the blowing connection (3).
- 2 Switch on the product.

10. Cleaning

WARNING!

Pull out the battery before carrying out any setting, servicing or repair work!

- It is recommended to clean the device after each use.
- Do not spray the device with water or clean it under running water. This can result in electric shocks and can damage the device.
- Residual liquid remains in the metal container (10). Pour out the liquid residue.
- Always keep the device clean. Do not use cleaning agents or solvents.
- Keep the ventilation slots clean and free of dirt and dust.
- Clean the device only with a soft brush or a damp cloth.

- Clean the foam filter (20) with a little soap and running water and then leave it to air dry.

11. Storage and transport

Store the device and its accessories in a dark, dry and frost-free place that is inaccessible to children. The optimum storage temperature is between 5 and 30°C.

Store the tool in its original packaging.

Cover the tool to protect it from dust or moisture.

Store the operating manual with the tool.

- There are four mounting holes (9a) on the base frame for storage of the floor nozzle (13), the crevice nozzle (15) and the extension tube (16).
- The remaining accessories can be stored in the metal container (10).

12. Maintenance

- Check the product for obvious defects such as loose, worn or damaged parts before each use.
- Check covers and protective devices for damage and correct fit. Replace them if necessary.

Replacing the filter (18, 20, 21) (Fig. 1, 6, 7, 8, 11)

1. Remove all insert tools from the bracket (22).
2. Remove the container lid (12).
3. Turn the container lid (12).
4. Pull the filter (18, 20) off the filter basket (19).
5. Attach the new filter (18, 20) to the filter basket (19).
6. Close the metal container (10) again with the container lid (12).

13. Disposal and recycling

The equipment is supplied in packaging to prevent it from being damaged in transit. The raw materials in this packaging can be reused or recycled. The equipment and its accessories are made of various types of material, such as metal and plastic. Defective components must be disposed of as special waste. Ask your dealer or your local council.

14. Troubleshooting

The following table shows fault symptoms and describes remedial measures in the event of your machine failing to work properly. If you cannot localise and rectify the problem with this, please contact your service workshop.

Fault	Possible cause	Remedy
Reduced vacuuming power.	Floor nozzle or crevice nozzle is blocked.	Switch off the vacuum cleaner. Remove blockage from the nozzle used.
	Paper filter bag is full of dust.	Change the Paper filter bag.



ALDI

FERREX®

Wet and Dry Vacuum Cleaner



Warranty Details

REGISTER YOUR PURCHASE AT www.aldi.com.au/en/about-aldi/product-registration/ TO KEEP UP-TO-DATE WITH IMPORTANT PRODUCT INFORMATION

The product is guaranteed to be free from defects in workmanship and parts for a period of 60 months from the date of purchase. Defects that occur within this warranty period, under normal use and care, will be repaired, replaced or refunded at our discretion. The benefits conferred by this warranty are in addition to all rights and remedies in respect of the product that the consumer has under the Competition and Consumer Act 2010 and similar state and territory laws.

Our goods come with guarantees that cannot be excluded under the Australian Consumer Law. You are entitled to a replacement or refund for a major failure and for compensation for any other reasonably foreseeable loss or damage. You are also entitled to have the goods repaired or replaced if the goods fail to be of acceptable quality and the failure does not amount to a major failure.

AFTER SALES SUPPORT

  1300 855 831

AUS Hotline Costs: Local rate for landline calls*
*Charges may vary dependent upon network operator or mobile network provider.

 support@scheppach.com.au

MODEL: F-WDV30P PRODUCT CODE: 717894 03/2025





Repair and Refurbished Goods or Parts Notice

Unfortunately, from time to time, faulty products are manufactured which need to be returned to the Supplier for repair.

Please be aware that if your product is capable of retaining user-generated data (such as files stored on a computer hard drive, telephone numbers stored on a mobile telephone, songs stored on a portable media player, games saved on a games console or files stored on a USB memory stick) during the process of repair, some or all of your stored data may be lost.

We recommend you save this data elsewhere prior to sending the product for repair.

You should also be aware that rather than repairing goods, we may replace them with refurbished goods of the same type or use refurbished parts in the repair process.

Please be assured though, refurbished parts or replacements are only used where they meet ALDI's stringent quality specifications.

If at any time you feel your repair is being handled unsatisfactorily, you may escalate your complaint. Please telephone us on SUPPLIER TELEPHONE or write to us at:



RossMac Pty. Ltd.

Unit 6, 4 Ovata Drive, Tullamarine, Victoria, 3043

Telephone: 1300 855 831 (Monday - Friday 8:00am-6:00pm)

Email: support@scheppach.com.au

AFTER SALES SUPPORT

  1300 855 831

AUS Hotline Costs: Local rate for landline calls*
*Charges may vary dependent upon network operator or mobile network provider.

 support@scheppach.com.au

MODEL: F-WDV30P PRODUCT CODE: 717894 03/2025