

ALDI GUARANTEES THAT OUR EXCLUSIVE BRAND PRODUCTS ARE DEVELOPED TO OUR STRINGENT QUALITY SPECIFICATIONS. IF YOU ARE NOT ENTIRELY SATISFIED WITH THIS PRODUCT, PLEASE RETURN IT TO THE NEAREST ALDI STORE WITHIN 60 DAYS FROM THE DATE OF PURCHASE, FOR A FULL REFUND OR REPLACEMENT, OR TAKE ADVANTAGE OF OUR AFTER SALES SUPPORT BY CALLING THE SUPPLIER’S CUSTOMER SERVICE HOTLINE.

**AU**  
Made in China  
FERREX® is a registered trademark of ALDI Stores  
DISTRIBUTED BY:  
ALDI STORES  
1 Sargents Road  
Minchinbury NSW 2770  
www.aldi.com.au

After Sales Support

**AU** 1300 855 831

support@scheppach.com.au

Model:  
F-DES12

07/2024

W<sup>2</sup>

835399

5

YEAR WARRANTY

FERREX®

CORDLESS SANDER F-DES12



Table of contents

1. Introduction .....	8
2. Product description (Fig. 1-5) .....	8
3. Scope of delivery (Fig. 1) .....	9
4. Proper use .....	9
5. Safety instructions.....	10
6. Technical data .....	16
7. Unpacking .....	17
8. Before commissioning.....	18
9. Operation.....	19
10. Working instructions .....	22
11. Cleaning and maintenance .....	23
12. Storage .....	23
13. Repair & ordering spare parts .....	24
14. Troubleshooting.....	25
15. Warranty Details .....	26
16. Repair and Refurbished Goods or Parts Notice .....	27
17. Exploded view.....	28

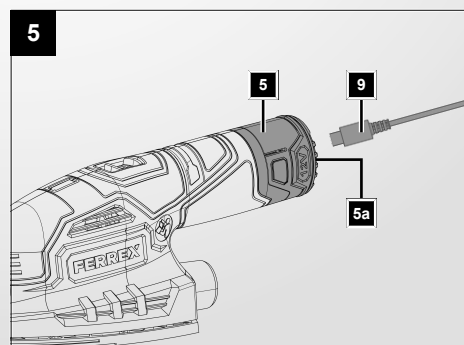
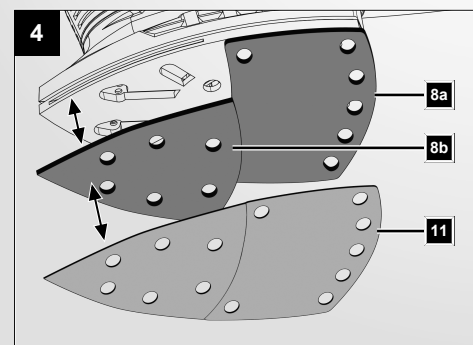
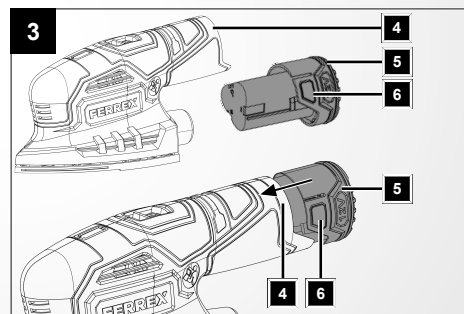
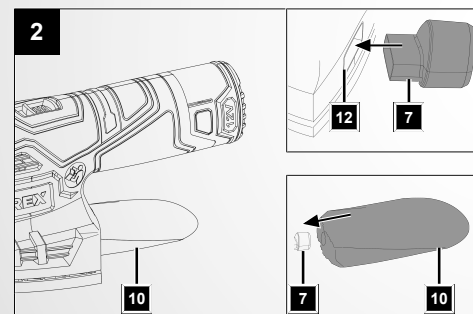
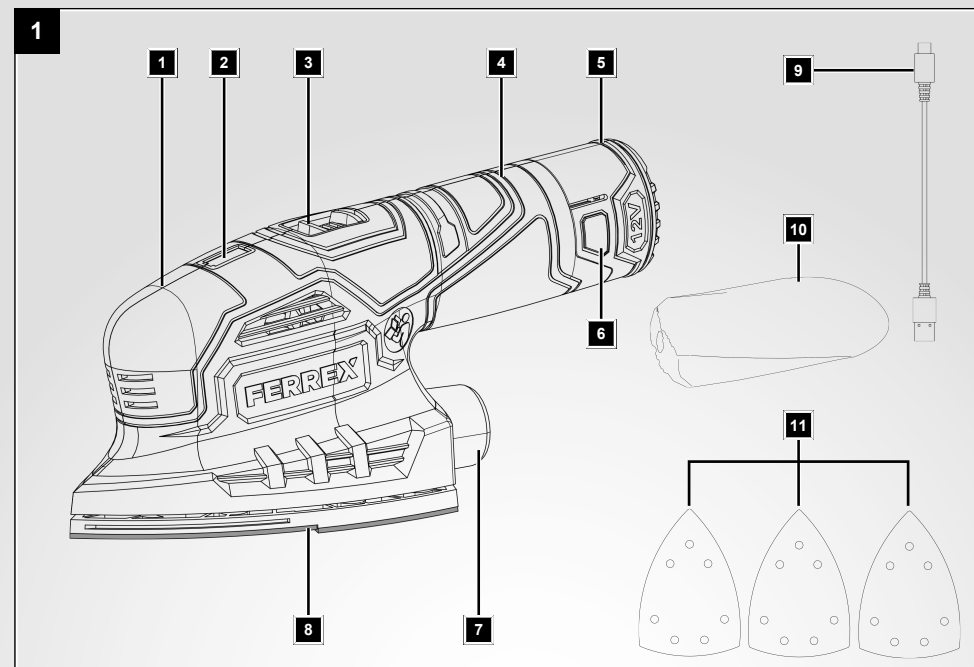













## Scope of delivery

- 1 x Battery
- 1 x Suction adapter
- 1 x USB charging cable
- 1 x Dust bag
- 3 x Sanding sheet (grain 60/120/240)
- 1 x Cordless sander
- 1 x Operating manual
- 1 x Warranty card

## Explanation of the symbols on the product

Symbols are used in this manual to draw your attention to potential hazards. The safety symbols and the accompanying explanations must be fully understood. The warnings themselves will not rectify a hazard and cannot replace proper accident prevention measures.

	Attention! Failure to observe the safety signs and warning information affixed to the product and failure to observe the safety and operating manual can result in serious injury or even death.
	Before commissioning, read and observe the operating manual and safety instructions!
	Wear safety goggles.
	Wear hearing protection.
	If dust builds up, wear respiratory protection!
	Do not throw the product into a fire.
	Do not throw the product into water.
	Regulatory Compliance Mark
	Warranty class
	Dispose of batteries according to local regulations.
	Lithium-ion battery
	5 year warranty

# 1. Introduction

## **Manufacturer:**

Scheppach GmbH  
Günzburger Straße 69  
D-89335 Ichenhausen

## **Dear Customer**

We hope your new product brings you much enjoyment and success.

## **Note:**

In accordance with the applicable product liability laws, the manufacturer of this product assumes no liability for damage to the product or caused by the product arising from:

- Improper handling
- Non-compliance with the operating manual
- Repairs carried out by third parties, unauthorised specialists
- Installing and replacing non-original spare parts
- Improper use
- Failures of the electrical system in the event of the electrical regulations not being observed.

## **Note:**

The operating manual is part of this product.

It includes important instructions for the safe, proper and economic operation of the product, for avoiding danger, for minimising repair costs and downtimes and for increasing the reliability and extending the service life of the product. In addition to the safety instructions in this operating manual, you must also observe the regulations applicable to the operation of the product in your country.

Familiarise yourself with all operating and safety instructions before using the product. Only operate the product as described and for the specified areas of application. Keep the operating manual in a good place and hand over all documents when passing the product on to third parties.

# 2. Product description (Fig. 1-5)

1. Handle
2. Charge status indicator (battery)
3. On/off switch
4. Battery mount



- 5. Battery
- 5a. Charging light
- 6. Release button (battery)
- 7. Suction adapter
- 8. Sanding pad
- 8a. Sanding pad base plate
- 8b. Sanding pad front plate
- 9. USB charging cable
- 10. Dust bag
- 11. Sanding sheet
- 12. Adapter connection

### 3. Scope of delivery (Fig. 1)

Item	Quantity	Designation
5.	1 x	Battery
7.	1 x	Suction adapter
9.	1 x	USB charging cable
10.	1 x	Dust bag
11.	3 x	Sanding sheet (grain 60/120/240)
	1 x	Cordless sander
	1 x	Operating manual
	1 x	Warranty card

### 4. Proper use

The product is intended for dry sanding of wood, metal, plastic, filler and painted surfaces.

The product may only be used in the intended manner. Any use beyond this is improper. The user/operator, not the manufacturer, is responsible for damages or injuries of any type resulting from this.

An element of the intended use is also the observance of the safety instructions, as well as the assembly instructions and operating information in the operating manual.

Persons who operate and maintain the product must be familiar with the manual and must be informed about potential dangers.

The liability of the manufacturer and resulting damages are excluded in the event of modifications of the product.

The product may only be operated with original parts and original accessories from the manufacturer.

The safety, operating and maintenance specifications of the manufacturer, as well as the dimensions specified in the technical data, must be observed.

Please note that our products were not designed with the intention of use for commercial or industrial purposes. We assume no guarantee if the product is used in commercial or industrial applications, or for equivalent work.

## 5. Safety instructions

### **WARNING**

**Read all safety warnings, instructions, illustrations and specifications provided with this power tool.**

Failure to follow all instructions listed below may result in electric shock, fire and/or serious injury.

**Save all warnings and instructions for future reference.**

The term “power tool” in the warnings refers to your mains-operated (corded) power tool or battery-operated (cordless) power tool.

### **1) Work area safety**

- a) **Keep your work area clean and well-lit.** Cluttered or dark areas invite accidents.
- b) **Do not operate power tools in explosive atmospheres, such as in the presence of flammable liquids, gases or dust.** Power tools create sparks which may ignite the dust or fumes.
- c) **Keep children and bystanders away while operating a power tool.** Distractions can cause you to lose control.

### **2) Electrical safety**

- a) **The connection plug of the electric tool must fit into the socket. Never modify the plug in any way. Do not use any adapter plugs with earthed (grounded) power tools.** Unmodified plugs and matching outlets will reduce risk of electric shock.
- b) **Avoid body contact with earthed or grounded surfaces, such as pipes, radiators, ranges and refrigerators.** There is an increased risk of electric shock if your body is earthed or grounded.

- c) **Do not expose power tools to rain or wet conditions.** Water entering a power tool will increase the risk of electric shock.
- d) **Do not abuse the cord. Never use the cord for carrying, pulling or unplugging the power tool. Keep cord away from heat, oil, sharp edges or moving parts.** Damaged or entangled cords increase the risk of electric shock.
- e) **When operating a power tool outdoors, use an extension cord suitable for outdoor use.** Use of a cord suitable for outdoor use reduces the risk of electric shock.
- f) **If operating a power tool in a damp location is unavoidable, use a residual current device (RCD) protected supply.** Use of an RCD reduces the risk of electric shock.

### 3) Personal safety

- a) **Stay alert, watch what you are doing and use common sense when operating a power tool. Do not use a power tool while you are tired or under the influence of drugs, alcohol or medication.** A moment of inattention while operating power tools may result in serious personal injury.
- b) **Wear personal protective equipment and always safety goggles.** Protective equipment such as a dust mask, non-skid safety shoes, safety helmet or hearing protection used for appropriate conditions will reduce personal injuries.
- c) **Prevent unintentional starting. Ensure the switch is in the off-position before connecting to power source and/or rechargeable battery, picking up or carrying the tool.** Carrying power tools with your finger on the switch or energising power tools that have the switch on invites accidents.
- d) **Remove any adjusting tools or spanners/keys before turning the power tool on.** A wrench or a key left attached to a rotating part of the power tool may result in personal injury.
- e) **Avoid abnormal postures. Keep proper footing and balance at all times.** This enables better control of the power tool in unexpected situations.
- f) **Dress properly. Do not wear loose clothing or jewellery. Keep your hair and clothing away from moving parts.** Loose clothes, jewellery or long hair can be caught in moving parts.
- g) **If devices are provided for the connection of dust extraction and collection facilities, ensure these are connected and properly used.** Use of dust extraction can reduce dust-related hazards.
- h) **Do not let familiarity gained from frequent use of tools allow you to become complacent and ignore tool safety principles.** A careless action can cause severe injury within a fraction of a second.

#### 4) Power tool use and care

- a) **Do not force the power tool. Use the correct power tool for your application.** The correct power tool will do the job better and safer at the rate for which it was designed.
- b) **Do not use the power tool if the switch does not turn it on and off.** Any power tool that cannot be controlled with the switch is dangerous and must be repaired.
- c) **Disconnect the plug from the power source and/or remove the battery pack, if detachable, from the power tool before making any adjustments, changing accessories, or storing power tools.** Such precautionary measures reduce the risk of starting the power tool accidentally.
- d) **Store idle power tools out of the reach of children and do not allow persons unfamiliar with the power tool or these instructions to operate the power tool.** Power tools are dangerous in the hands of untrained users.
- e) **Maintain power tools and attachments. Check for misalignment or binding of moving parts, breakage of parts and any other condition that may affect the power tool's operation. If damaged, have the power tool repaired before use.** Many accidents are caused by poorly maintained power tools.
- f) **Keep cutting tools sharp and clean.** Properly maintained cutting tools with sharp cutting edges are less likely to bind and are easier to control.
- g) **Use electric tools, insertion tools, etc. according to these instructions. Take into account the working conditions and the work to be performed.** Use of the power tool for operations different from those intended could result in a hazardous situation.
- h) **Keep handles and grasping surfaces dry, clean and free from oil and grease.** Slippery handles and grasping surfaces do not allow for safe handling and control of the tool in unexpected situations.

#### 5) Battery tool use and care

- a) **Only charge the batteries with battery chargers recommended by the manufacturer.** A battery charger that is suitable for a particular type of battery poses a fire hazard when used with other batteries.
- b) **Only use the batteries in power tools that are designed for them.** The use of other batteries can lead to injuries and a risk of fire.
- c) **Keep the unused battery away from paper clips, coins, keys, nails, screws or other small metal objects that could cause a short-circuit between the contacts.** A short-circuit between the contacts of the battery could result in burns or fires.

- d) **Liquid may leak from the battery if used incorrectly. Avoid contact with it. In case of accidental contact, rinse with water. If the liquid gets into your eyes, seek additional medical attention.** Leaking battery fluid may cause skin irritation or burns.
- e) **Do not use a damaged or modified battery.** Damaged or modified batteries can behave unpredictably and cause fire, explosion or injury.
- f) **Do not expose a battery to fire or excessive temperatures.** Fire or temperatures above 130°C may cause an explosion.
- g) **Follow all charging instructions and never charge the battery or rechargeable tool outside the temperature range specified in the operating manual.** Incorrect charging or charging outside the approved temperature range can destroy the battery and increase the risk of fire.

## 6) Service

- a) **Only have your power tool repaired by qualified specialists and only with original spare parts.** This will ensure that the safety of the power tool is maintained.
- b) **Never attempt to service damaged batteries.** Any type of battery maintenance shall be carried out only by the manufacturer or an authorised customer service centre.

## Special safety instructions for cordless orbital sanders

### **WARNING**

- Dusts from materials such as paint containing lead, some types of wood and metal can be harmful to health.
  - Touching or inhaling such dust may pose risks for the operator or bystanders.
  - Wear safety goggles and a dust mask!
- 1. **Secure the workpiece.** A workpiece held with a clamping device or bench vice is held more securely than with your hand.
  - 2. **Only use the electric tool for dry sanding. Do not scrape wet materials.** Water penetrating an electric device increases the risk of an electric shock.
  - 3. **Avoid overheating the grinding material and the grinder.** There is a risk of fire.
  - 4. **The workpiece becomes hot during machining. Do not touch the machined area, let it cool down.** There is a risk of burns. Do not use coolant or similar.

5. **Always empty the dust bag before work breaks.** Grinding dust in the dust bag, microfilter, paper bag (or in the filter bag or filter of the vacuum cleaner) can self-ignite under unfavourable conditions, such as flying sparks when grinding metals. There is a particular danger if the grinding dust is mixed with paint, polyurethane residues or other chemical substances and the sanding material is hot after working for a long time. Also refer to the operating instructions of your Hoover to see if it is suitable for vacuuming up sanding chips.
6. Avoid processing materials that are harmful to health, such as asbestos or lead-based paints.
7. Wait until the product has come to a standstill before placing it down.

### Residual risks

**The product has been built according to state-of-the-art and the recognised technical safety rules. However, individual residual risks can arise during operation.**

- Damage to hearing if the stipulated hearing protection is not worn.
- Residual risks can be minimised if the "Safety Instructions" and the "Intended Use" together with the operating manual as a whole are observed.
- Use the product in the way that is recommended in this operating manual. This is how to ensure that your product provides optimum performance.
- Furthermore, despite all precautions having been met, some non-obvious residual risks may still remain.

#### **WARNING**

This power tool generates an electromagnetic field during operation. This field can impair active or passive medical implants under certain circumstances. In order to prevent the risk of serious or deadly injuries, we recommend that persons with medical implants consult with their physician and the manufacturer of the medical implant prior to operating the power tool.



**⚠ WARNING**

In case of extended working periods, the operating personnel may suffer circulatory disturbances in their hands (vibration white finger) due to vibrations.

Raynaud's syndrome is a vascular disease that causes the small blood vessels on the fingers and toes to cramp in spasms. The affected areas are no longer supplied with sufficient blood and therefore appear extremely pale. The frequent use of vibrating products can cause nerve damage in people whose circulation is impaired (e.g. smokers, diabetics).

If you notice unusual adverse effects, stop working immediately and seek medical advice.

## Explanation of the signal words in the operating manual

**⚠ DANGER**

**Signal word to indicate an imminently hazardous situation which, if not avoided, will result in death or serious injury.**

**⚠ WARNING**

**Signal word to indicate a potentially hazardous situation which, if not avoided, could result in death or serious injury.**



**⚠ CAUTION**

**Signal word to indicate a potentially hazardous situation which, if not avoided, could result in minor or moderate injury.**

**ATTENTION**

**Signal word to indicate a potentially hazardous situation which, if not avoided, could result in product or property damage.**

## 6. Technical data

Engine voltage	12 V 
Oscillation rate	13,000 rpm
Sanding wheel	15x10 mm
Weight (without battery)	0.494 kg
<b>Battery (Li-Ion)</b>	
Number of battery cells	3
Rated voltage	max. 12 V 
Capacity	1.3 Ah
Power	15.6 Wh
Charging process temperature	50°C
Charging time	3–4.5 h

### Noise and vibration

 <b>WARNING</b>
Noise can have serious effects on your health. If the machine noise exceeds 85 dB, please wear suitable hearing protection for you and persons in the vicinity.

The noise and vibration values have been determined in accordance with AS/NZS 62841-1.

### Noise data

Sound pressure $L_{pA}$	73.2 dB
Measurement uncertainty $K_{pA}$	3 dB
Sound power $L_{wA}$	84.2 dB
Measurement uncertainty $K_{wA}$	3 dB

### Vibration parameters

Vibration $a_h$	0.571 m/s <sup>2</sup>
Measurement uncertainty K	1.5 m/s <sup>2</sup>

The total vibration emission values specified and the device emissions values specified have been measured in accordance with a standardised test procedure and can be used for comparison of one electric tool with another.

The total noise emission values specified and the total vibration emission values specified can also be used for an initial estimation of the load.

### **WARNING**

**The noise emission values and vibration emission value can vary from the specified values during the actual use of the power tool, depending on the type and the manner in which the electric tool is used, and in particular the type of workpiece being processed.**

Try to keep the stress as low as possible. For example: Limit working time. In doing so, all parts of the operating cycle must be taken into account (such as times in which the power tool is switched off or times in which it is switched on, but is not running under a load).

## 7. Unpacking

### **WARNING**

**The product and the packaging material are not children's toys!  
Do not let children play with plastic bags, films or small parts!  
There is a danger of choking or suffocating!**

- Open the packaging and carefully remove the product.
- Remove the packaging material, as well as the packaging and transport safety devices (if present).
- Check whether the scope of delivery is complete.
- Check the product and accessory parts for transport damage. Immediately report any damage to the transport company that delivered the Product. Later claims will not be recognised.
- If possible, keep the packaging until the expiry of the warranty period.
- Familiarise yourself with the product by means of the operating manual before using for the first time.
- With accessories as well as wearing parts and replacement parts use only original parts. Spare parts can be obtained from your specialist dealer.
- When ordering please provide our article number as well as type and year of manufacture for the product.

## 8. Before commissioning

### **WARNING**

#### **Danger of injury!**

Remove the battery from the power tool before carrying out any work on the power tool (e.g. maintenance, tool change, etc.) and when transporting and storing it. There is a risk of injury if the on/off switch is operated unintentionally.

- Empty the dust bags or the dust extraction unit in good time to ensure optimum suction performance.

### **8.1. Attach/remove/empty the suction adapter (7) and dust bag (10) (Fig. 2)**

#### **8.1.1. Attaching the suction adapter and dust bag**

1. Attach the suction adapter (7) to the adapter connection (12).
2. Slide the dust bag (10) onto the suction adapter (7) as far as it will go.
3. Ensure that the dust bag (10) is correctly attached to the suction adapter (7).

#### **8.1.2. Remove the dust bag and suction adapter**

1. Remove the dust bag (10) from the suction adapter (7).
2. Now remove the suction adapter (7) from the adapter connection (12).

#### **8.1.3. Emptying the dust bag**

1. Remove the dust bag (10) from the suction adapter (7) and empty the dust bag (10).
2. Slide the dust bag (10) onto the suction adapter (7) as far as it will go.
3. Ensure that the dust bag (10) is correctly attached to the suction adapter (7).

### **8.2. Connecting/taking off the external dust extraction unit**

#### **8.2.1. Connecting external dust extraction unit (Fig. 1)**

1. Remove the dust bag (10) from the suction adapter (7).
2. Connect an approved dust extraction unit (not included in the scope of delivery) to the suction adapter (7).

### 8.2.2. Taking off the external dust extraction unit

1. Take off the vacuum hose of the approved dust extraction unit (not included in the scope of delivery) from the suction adapter (7).

### 8.3. Inserting/removing the battery (5) into/from the battery mount (4) (Fig. 3)

#### Inserting the battery

1. Push the battery (5) into the battery mount (4). The battery (5) clicks into place audibly.

#### Removing the battery

1. Press the release button (6) of the battery (5) and remove it from the battery mount (4).

### 8.3.1. Charge level indicator (2) (Fig. 1)

The charge status indicator (2) indicates the charge status of the battery (5).

The charge status of the battery is indicated by the corresponding LED light lighting up.

1. Push the ON/OFF switch (3) into position I to check the charging status.

RED/ORANGE/GREEN	Battery fully charged
RED/ORANGE	Battery partially charged
RED	Battery must be charged

## 9. Operation

### WARNING

#### Danger of injury!

Remove the battery from the power tool before carrying out any work on the power tool (e.g. maintenance, tool change, etc.) and when transporting and storing it. There is a risk of injury if the on/off switch is operated unintentionally.

### ATTENTION

Make sure that the ambient temperature does not exceed 50°C and does not fall below -20°C during work.

### 9.1. Switching the product on/off (Fig. 1)

**Note:**

Always switch the product on before making contact with the material and then guide the product to the workpiece.

#### Switching on

1. Push the ON/OFF switch (3) into position I to switch the product on.  
The on/off switch (3) remains in position.

#### Switching off

1. Push the ON/OFF switch (3) into position 0 to switch off the product.

### 9.2. Changing the sanding sheet (11) (Fig. 4)

The sanding sheet (11) can be switched to machine different materials. There are also different grain sizes for coarse sanding and fine sanding.

**Note:**

Ensure that the sanding sheet is switched before it is worn out, otherwise the sanding sheet may tear and the workpiece may be damaged.

**Note:**

Clean the sanding pad before putting on a sanding sheet.

#### ATTENTION

Only use sanding sheets that match in size. Larger sanding sheets extending beyond the sanding pad presents a laceration hazard and may cause snagging or tearing of the sanding sheets.

**Note:**

The sanding pad is equipped with a hook and loop tape for quick attachment of the sanding sheet.

#### 9.2.1. Attaching sanding sheets

1. Press the sanding sheet (11) evenly onto the sanding pad (8).  
Ensure that the sanding sheet (11) lies flush and that the holes are congruent with the suction holes of the sanding pad (8).

#### 9.2.2. Removing sanding sheets

1. Take off the sanding sheet (11) from the sanding pad (8).



### 9.3. Changing the sanding pad (8) (Fig. 4)

The supplied sanding pad (8) consists of two parts:

the base plate (8a) and the exchangeable front plate (8b).

The front plate (8b) is fitted with a hook and loop tape and can be replaced.

1. Grasp the front plate (8b) of the sanding pad (8) at one tip and pull it off.

### 9.4. Charging the battery (5) (Fig. 5)

#### **WARNING**

##### **Observe the following information to reduce hazards:**

- Never leave batteries to charge unsupervised!
- Remove rechargeable batteries from the USB charging cable after charging.
- Do not over-charge batteries! Observe the maximum charging times. These charging times only apply to discharged batteries. Inserting a charged or partially charged battery multiple times leads to overloading and cell damage. Do not leave batteries charging for longer than required.

Charge the battery (5) at an ambient temperature of 4 °C to 45°C.

\* = may not be included in the scope of delivery!

1. Connect the USB charging cable (9) to the battery (5).
2. Connect the USB charging cable (9) to a mains plug\* and plug the mains plug\* into a socket.
3. The battery (5) comes with a charging light (5a).
  - When the battery is charging, the red light will be on.
  - Red light goes out when the battery is fully charged.
4. After charging, remove the mains plug\* from the socket and disconnect the USB charging cable (9) from the battery (5).
5. Wait at least 15 min until a new charging process. To do this, pull the mains plug\* out of the socket.

### 9.5. Depleted batteries

- A significantly shortened operating time despite charging indicates that the battery has been used up and needs to be replaced. Only use original replacement batteries.

- In any case, observe the applicable safety instructions as well as regulations and instructions on environmental protection (see “Disposal and recycling”).

## 10. Working instructions

### **Note:**

#### **Negligent use of personal protective equipment (PPE)**

Careless use or omission of personal protective equipment may result in serious injury.

#### **WARNING**

Do not use the product without the dust bag or external dust extraction unit in place.

Using a dust extraction unit can reduce hazards caused by dust.

Dust extraction is not possible when using sanding sheets without holes.

Ensure that the workplace is well ventilated.

### **Note:**

Clean the sanding pad before putting on a sanding sheet.

- **Always guide the product against the workpiece when switched on.** After machining, lift the product from the workpiece and only then switch it off.
- Only work with flawless sanding sheets to obtain good sanding results.
- Ensure that the contact pressure is even. Excessively increasing the contact pressure does not lead to a higher sanding rate, but to greater wear on the sanding sheets.
- Do not use a sanding sheet with which metal has been machined for other materials.
- Empty the dust bags or the dust extraction unit in good time to ensure optimum suction performance.

## 11. Cleaning and maintenance

### **WARNING**

**Have maintenance and repair tasks that are not described in this operating manual, carried out by a specialist workshop. Use only original spare parts.**

**There is a risk of accident! Always perform maintenance and cleaning work with the battery removed. There is a danger of injury! Let the product cool down before all maintenance and cleaning tasks. Elements of the engine are hot. There is a danger of injury and burning!**

The product can start unexpectedly and cause injuries.

- Remove the battery.
- Allow the product to cool down.
- Remove the tool attachment.

### **11.1. Cleaning**

1. Keep protective devices, air vents and the motor housing as free of dust and dirt as possible. Rub the product clean with a clean cloth\* or blow it off with compressed air\* at low pressure. We recommend that you clean the product directly after every use.
2. Ventilation openings must always be free.
3. Do not use any cleaning products or solvents; they could attack the plastic parts of the product. Make sure that no water can penetrate the product interior.
4. Clean the sanding sheet with a dust extraction unit or tap it out.

### **11.2. Maintenance**

The product is maintenance-free.

## 12. Storage

### **Preparation for storage**

1. Remove the battery.
2. Clean and check the product for damage.

Store the product and its accessories in a dark, dry and frost-free place that is inaccessible to children.

The optimum storage temperature is between 5°C and 30°C.

Store the product in its original packaging.

Cover the product to protect it from dust or moisture. Store the operating manual with the product.

## 13. Repair & ordering spare parts

After repairs or maintenance, make sure that all safety-related parts are installed and are in perfect condition. All parts which may cause injury must be kept where they are inaccessible to children or others.

### ATTENTION

No liability is accepted for damage caused by improper repairs or by not using original spare parts.

Such work should be performed by a customer service centre or an authorised specialists. The same applies to accessory parts.

### 13.1. Ordering spare parts

Please provide the following information when ordering spare parts:

- Model designation
- Item number
- Type plate data

### 13.2. Service information

With this product, it is necessary to note that the following parts are subject to natural or usage-related wear, or that the following parts are required as consumables.

Wearing parts: Sanding sheet, sanding pad, front plate, battery

## 14. Troubleshooting

Fault	Possible cause	Remedy
The sander is not working.	The battery power is too weak.	Charge the battery.
	The battery is not properly inserted.	Push the battery into the battery mount. The battery clicks into place audibly.
	The contacts on the product or battery are dirty.	Remove any existing dirt.
No material is removed.	The sanding sheet is worn/defective.	Clean or replace the sanding sheet.
	The grit of the sanding sheet is too fine.	Use a sanding sheet with a coarser grit.
The sanding sheet can no longer be attached to the sanding disc.	The front plate of the sanding disc is worn/defective.	Replace the front plate of the sanding disc.
The sander has switched off during use.	The battery is discharged.	Charge the battery.

# 15. Warranty Details



## FERREX<sup>®</sup> CORDLESS SANDER

### Warranty Details

---

REGISTER YOUR PURCHASE AT [www.aldi.com.au/en/about-aldi/product-registration/](http://www.aldi.com.au/en/about-aldi/product-registration/)  
TO KEEP UP-TO-DATE WITH IMPORTANT PRODUCT INFORMATION

---

The product is guaranteed to be free from defects in workmanship and parts for a period of 60 months (dependant on product) from the date of purchase. Defects that occur within this warranty period, under normal use and care, will be repaired, replaced or refunded at our discretion. The benefits conferred by this warranty are in addition to all rights and remedies in respect of the product that the consumer has under the Competition and Consumer Act 2010 and similar state and territory laws.

Our goods come with guarantees that cannot be excluded under the Australian Consumer Law. You are entitled to a replacement or refund for a major failure and for compensation for any other reasonably foreseeable loss or damage. You are also entitled to have the goods repaired or replaced if the goods fail to be of acceptable quality and the failure does not amount to a major failure.

---

AFTER SALES SUPPORT

1300 855 831

[support@scheppach.com.au](mailto:support@scheppach.com.au)





## 16. Repair and Refurbished Goods or Parts Notice



# FERREX®

CORDLESS SANDER

## Repair and Refurbished Goods or Parts Notice

---

REGISTER YOUR PURCHASE AT [www.aldi.com.au/en/about-aldi/product-registration/](http://www.aldi.com.au/en/about-aldi/product-registration/)  
TO KEEP UP-TO-DATE WITH IMPORTANT PRODUCT INFORMATION

---

Unfortunately, from time to time, faulty products are manufactured which need to be returned to the Supplier for repair.

Please be aware that if your product is capable of retaining user-generated data (such as files stored on a computer hard drive, telephone numbers stored on a mobile telephone, songs stored on a portable media player, games saved on a games console or files stored on a USB memory stick) during the process of repair, some or all of your stored data may be lost.

**We recommend you save this data elsewhere prior to sending the product for repair.**

You should also be aware that rather than repairing goods, we may replace them with refurbished goods of the same type or use refurbished parts in the repair process.

**Please be assured though, refurbished parts or replacements are only used where they meet ALDI's stringent quality specifications.**

If at any time you feel your repair is being handled unsatisfactorily, you may escalate your complaint. Please telephone us on 1300 855 831 or write to us at:

RossMac Pty. Ltd.  
Unit 6, 4 Ovata Drive, Tullamarine, Victoria, 3043, Australia  
1300 855 831  
[support@scheppach.com.au](mailto:support@scheppach.com.au)

Opening hours:  
Monday - Friday 8:00am-6:00pm

---

AFTER SALES SUPPORT

1300 855 831

[support@scheppach.com.au](mailto:support@scheppach.com.au)



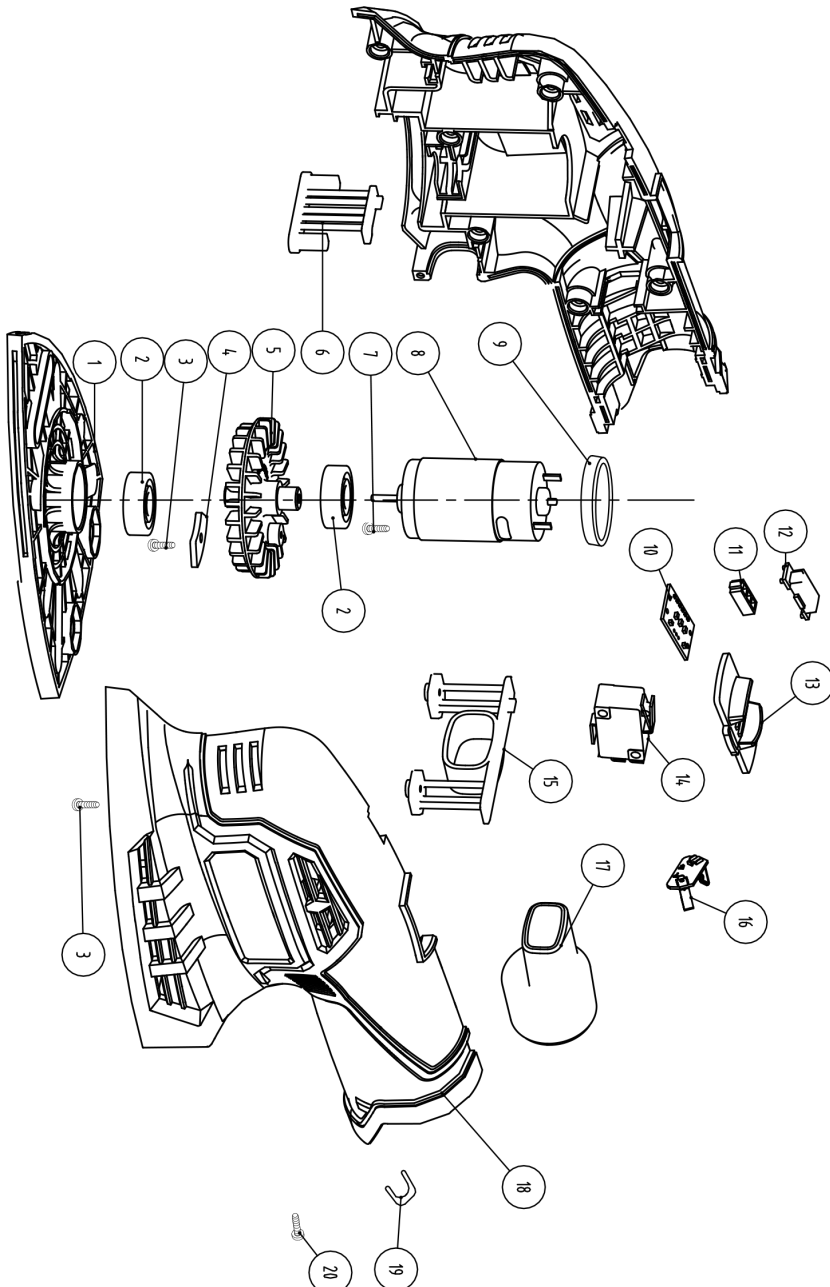

---

## Notes

---

# Notes